

# Woodman Close • Sparsholt

## Information Event

April 2021

HOUSING FOR   
**WINCHESTER**

### This is a pre-recorded information event

Comments will be accepted until Monday 10th May 2021. Please email your comments to:  
**[newhomes@Winchester.gov.uk](mailto:newhomes@Winchester.gov.uk)**

We aim to publish the comments by Monday 17th May 2021. This can be found at:  
**[www.winchester.gov.uk/woodman-close](http://www.winchester.gov.uk/woodman-close)**

Winchester City Council is adapting to find new ways to communicate with you. We would welcome your feedback after watching this pre-recorded information event, so that we can continue to develop and improve the service we provide. **A short survey can be found on the event link and we welcome your views.**

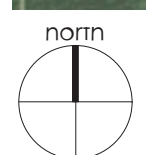

Site identified for development outlined in red.

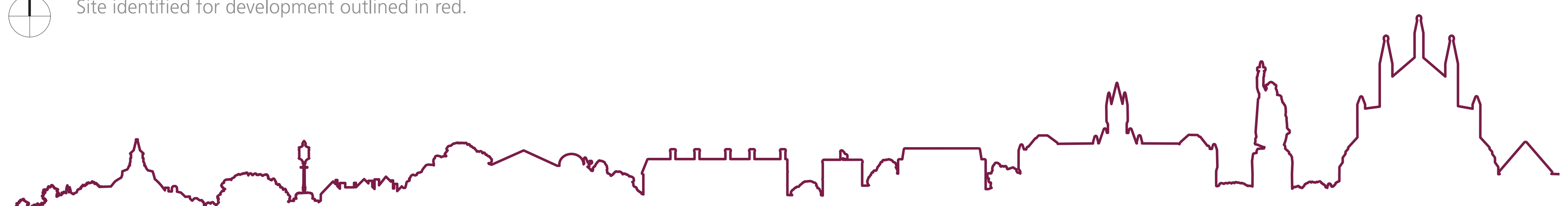



# Woodman Close • Sparsholt

## Introduction and Aims

April 2021

HOUSING FOR   
**WINCHESTER**

### Introduction

Winchester City Council is proposing to develop a small number of council homes on land owned by the council -

- All of the new homes would be owned and managed by the council
- It is intended that the homes would be for rent
- The properties would be available to people with a recognised local connection to Sparsholt

### Aims

- To update residents on the scheme proposals prior to a planning application
- To provide information on the energy efficiency standard of the homes
- To encourage local people in housing need to register with Hampshire Home Choice

### Why is Winchester City Council considering developing new homes at Woodman Close?

- There is a serious shortage of affordable homes in the district with demand hugely outstripping supply
- There is an identified need within Sparsholt Parish for new affordable homes
- The land identified can accommodate a small number of council homes to meet local needs
- The council is able to make significant savings by building new council homes for rent on land that it owns, ensuring value for money and that rents can be kept as low as possible

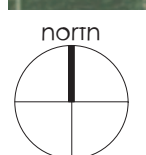

Site identified for development outlined in red.

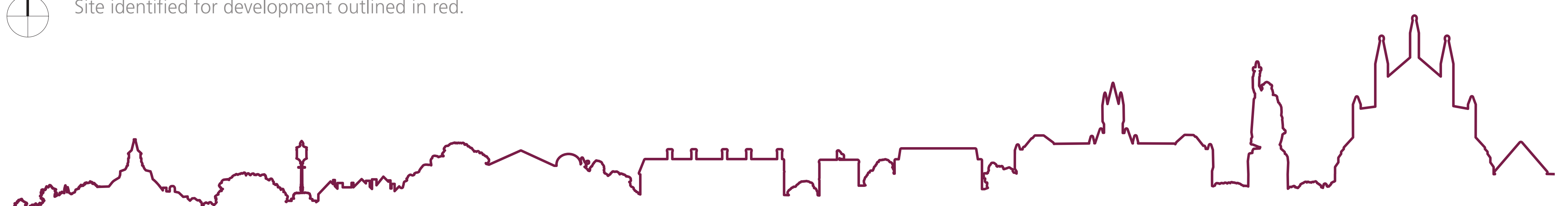



# November 2019

# HOUSING FOR WINCHESTER

## Key Points

- 7 no. on site parking spaces
- Site access from Bostock Close
- New planting proposed

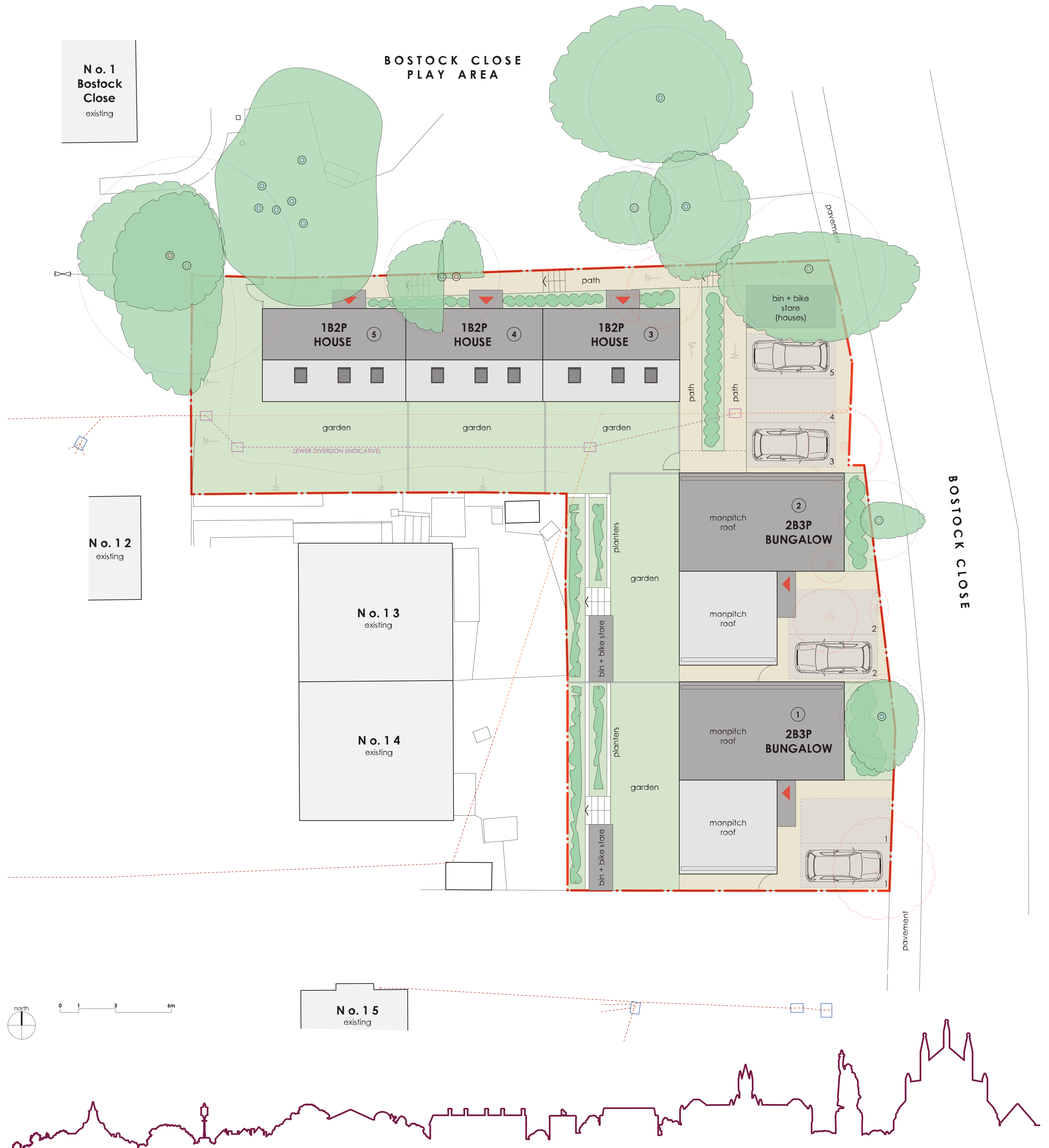

# Woodman Close • Sparsholt

## Proposed Scheme - Site Layout Plan

April 2021

HOUSING FOR  
**WINCHESTER**

### Key Points

- 5 no. small dwellings proposed -
  - 3 no. 1 bedroom, 2 person houses
  - 2 no. 2 bedroom, 3 person bungalows
- 7 no. on site parking spaces
- Site access from Bostock Close
- New planting proposed

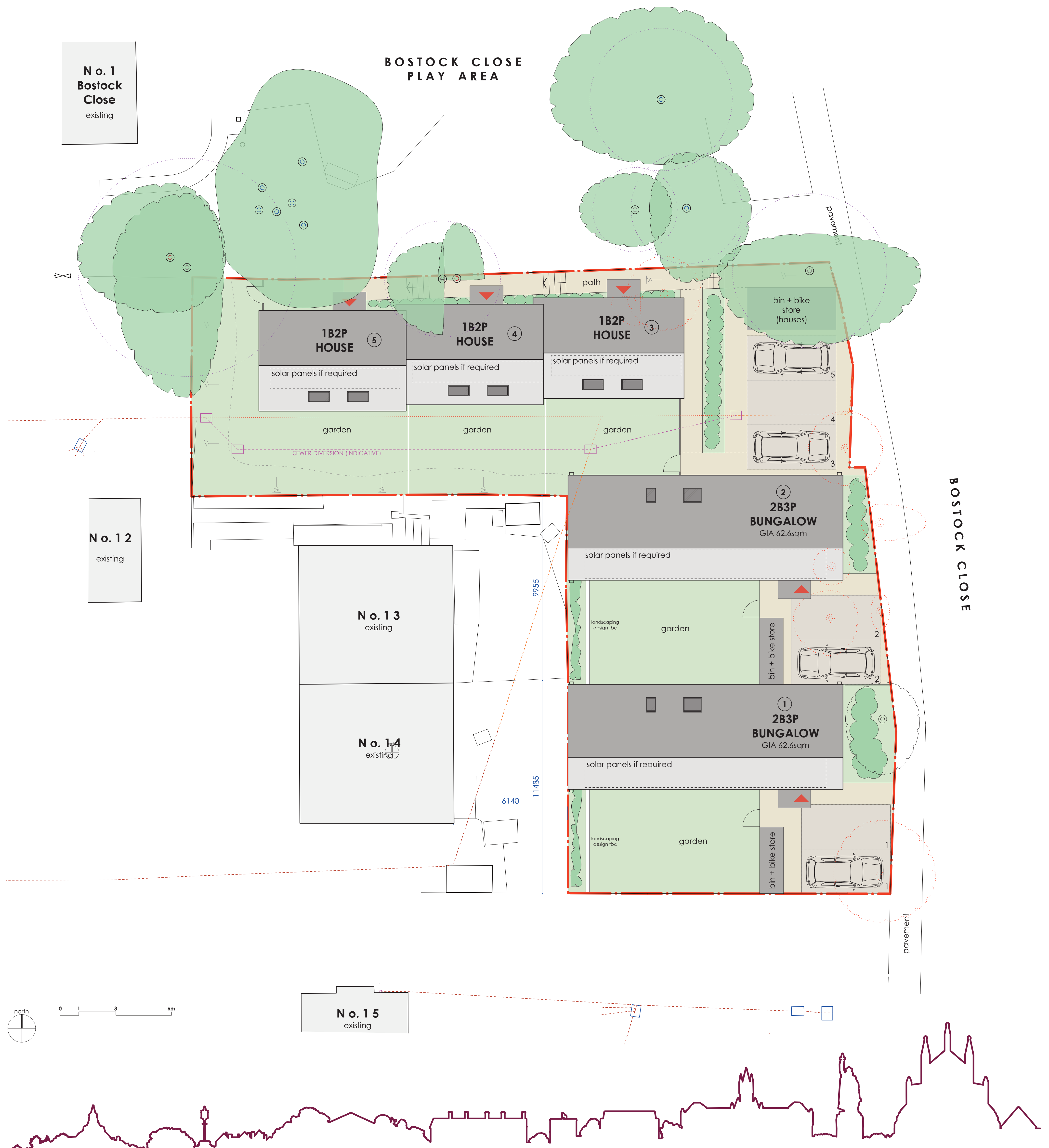



# Woodman Close • Sparsholt

## Original Scheme - Site Overview

November 2019

HOUSING FOR   
**WINCHESTER**

### Key Points

- 5 no. small dwellings proposed -
  - 3 no. 1 bedroom, 2 person houses
  - 2 no. 2 bedroom, 3 person bungalows
- 7 no. on site parking spaces
- Site access from Bostock Close
- New planting proposed



### A. Proposed Aerial View of Site

(Proposed materials not currently shown - for form and massing purposes only)

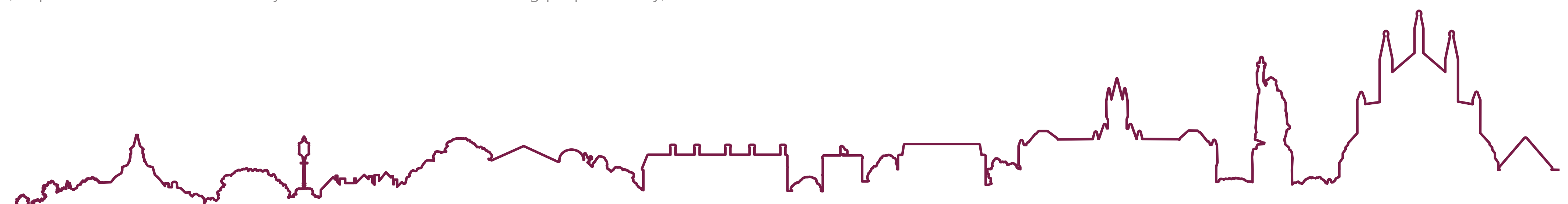



# Woodman Close • Sparsholt

## Proposed Scheme - Site Overview

April 2021

HOUSING FOR   
**WINCHESTER**

### Key Points

- 5 no. small dwellings proposed -
  - 3 no. 1 bedroom, 2 person houses
  - 2 no. 2 bedroom, 3 person bungalows
- 7 no. on site parking spaces
- Site access from Bostock Close
- New planting proposed



A. Proposed Aerial View of Site

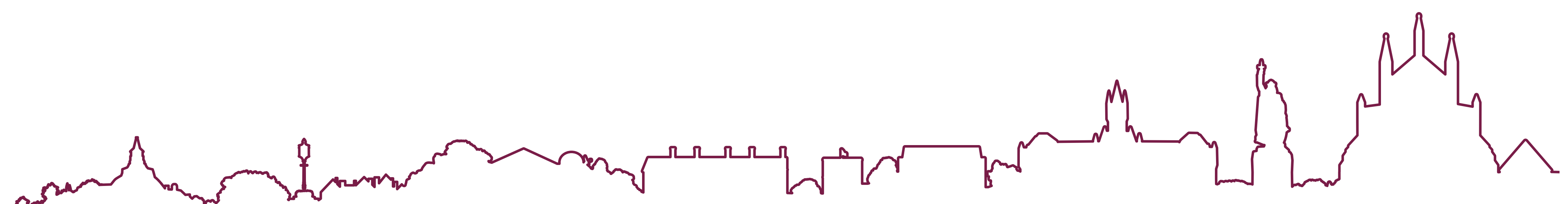



# Woodman Close • Sparsholt

## Original Scheme - Elevation and Section

November 2019

HOUSING FOR   
**WINCHESTER**

### Key Points

- 5 no. small dwellings proposed -
  - 3 no. 1 bedroom, 2 person houses
  - 2 no. 2 bedroom, 3 person bungalows
- 7 no. on site parking spaces
- Site access from Bostock Close
- New planting proposed

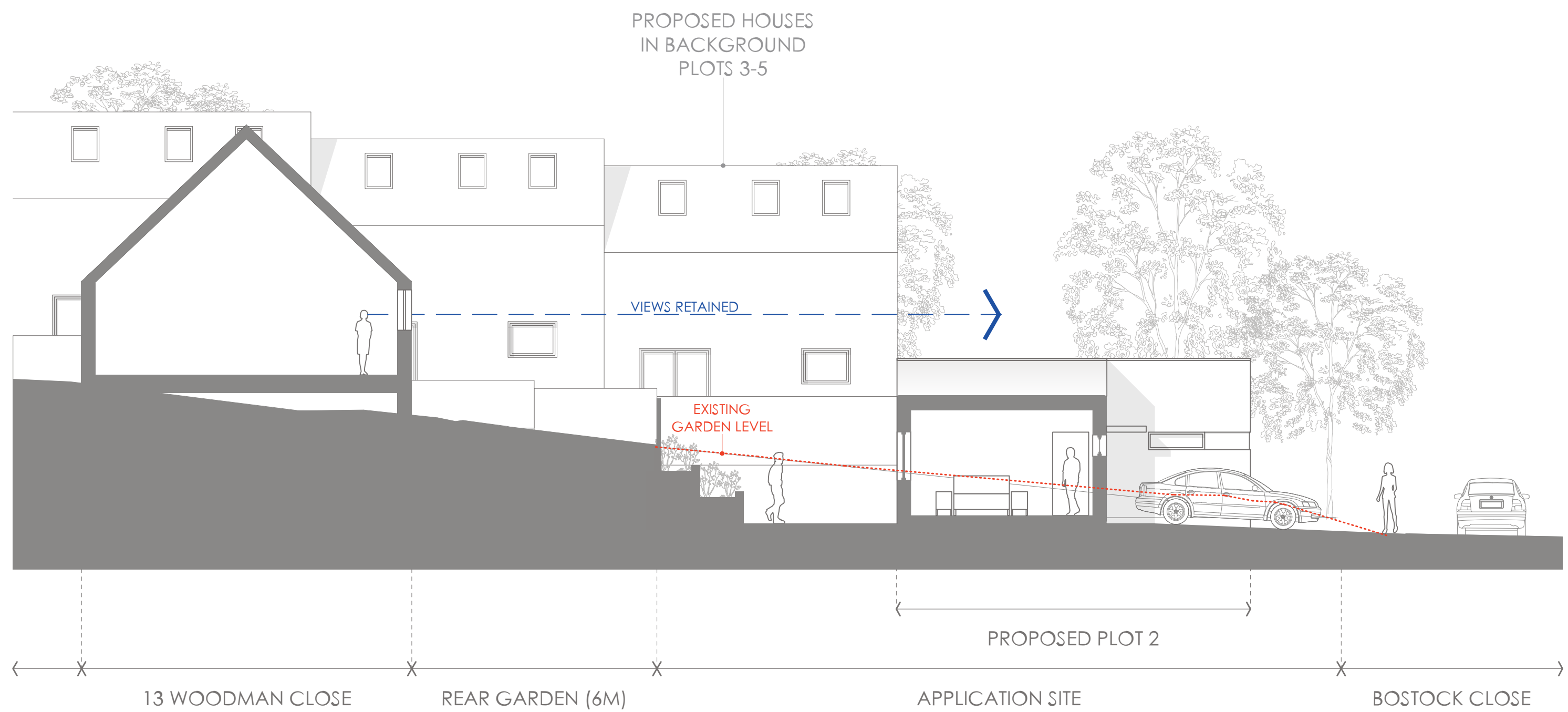

### A. Site Section

(proposed materials not currently shown - for form and massing purposes only)

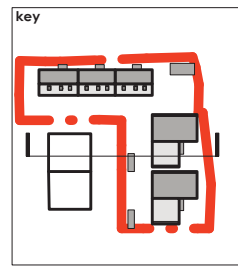

### B. Street Scene Elevation

(proposed materials not currently shown - for form and massing purposes only)

0 1 3 6m

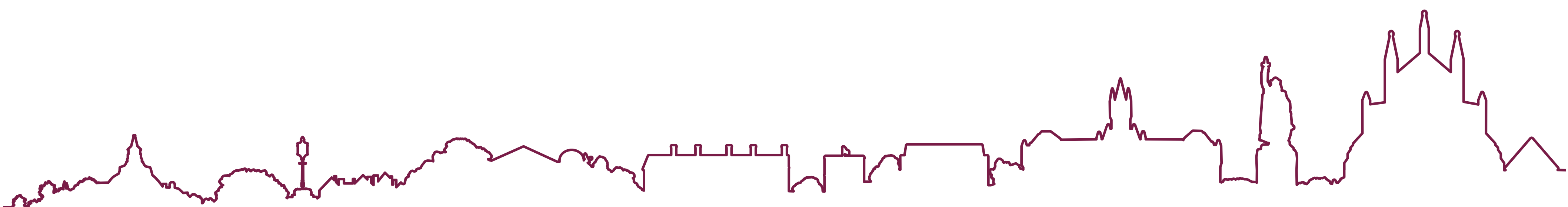
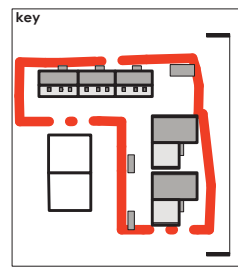



# Woodman Close • Sparsholt

## Proposed Scheme - Elevation and Section

April 2021

HOUSING FOR   
**WINCHESTER**

### Key Points

- 5 no. small dwellings proposed -
  - 3 no. 1 bedroom, 2 person houses
  - 2 no. 2 bedroom, 3 person bungalows
- 7 no. on site parking spaces
- Site access from Bostock Close
- New planting proposed

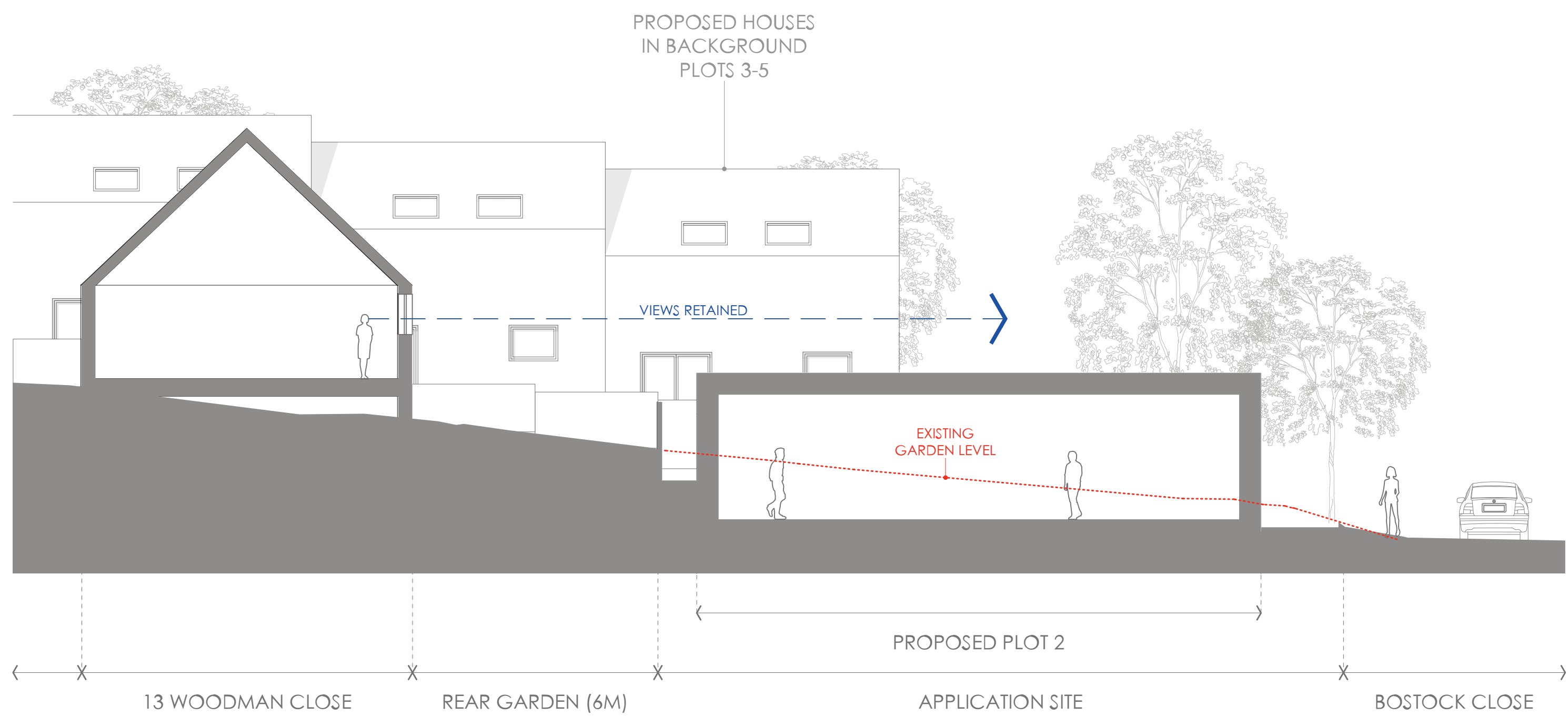

### A. Site Section

(proposed materials not currently shown - for form and massing purposes only)

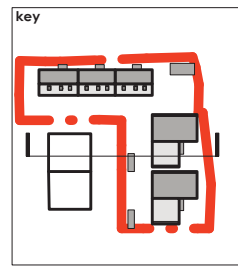

### B. Street Scene Elevation

0 1 3 6m

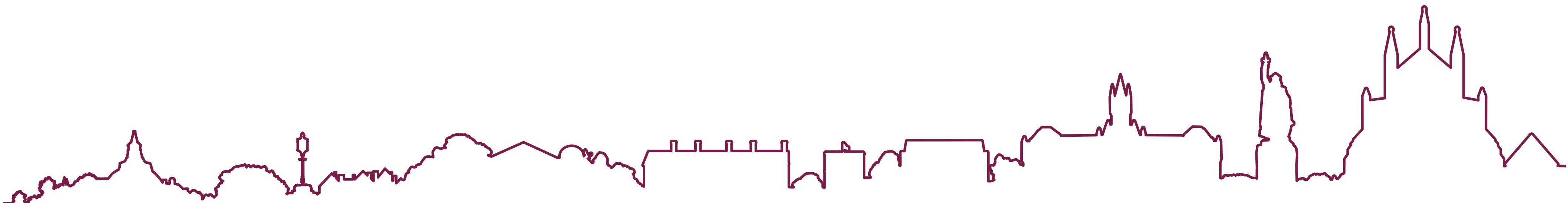
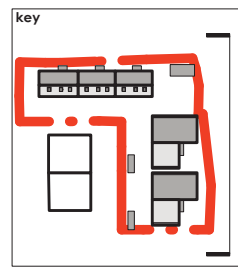



Woodman Close • Sparsholt  
**Original Scheme - 3D Views**  
November 2019

HOUSING FOR   
**WINCHESTER**



A. Proposed View from Bostock Close - Looking West  
(proposed materials not currently shown - for form and massing purposes only)

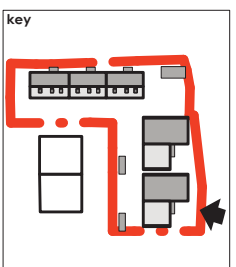

B. Proposed View from Bostock Close - Looking South  
(proposed materials not currently shown - for form and massing purposes only)

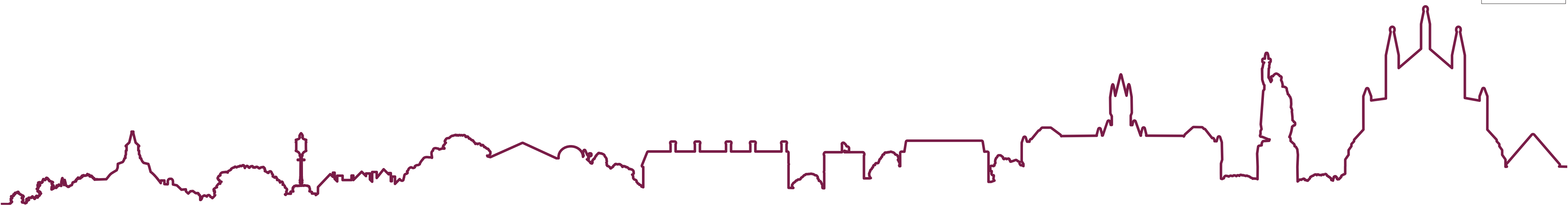
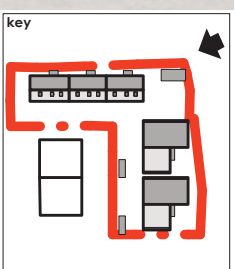



Woodman Close • Sparsholt  
**Proposed Scheme - 3D Views**  
April 2021

HOUSING FOR   
**WINCHESTER**



A. Proposed View from Bostock Close - Looking West

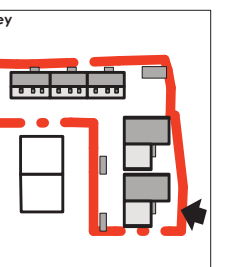

B. Proposed View from Bostock Close - Looking South

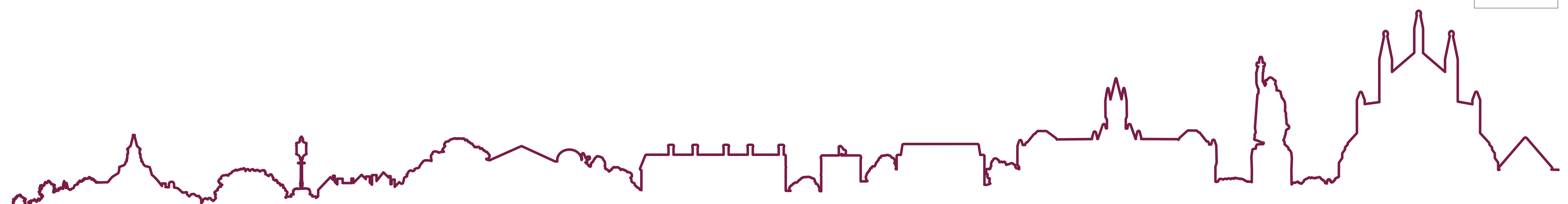
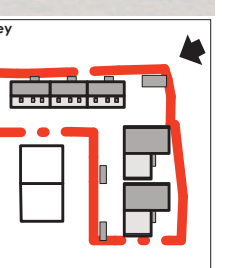



# Woodman Close • Sparsholt

## Appearance and Materials

April 2021

HOUSING FOR   
**WINCHESTER**

Examples of existing homes in the surrounding area.



Examples of what the development could look like, and suggested materials.



Bell Phillips Architects



Mikhail Riches



Patel Taylor

Below are examples of other schemes completed by Winchester City Council since the establishment of its New Homes Programme in 2012.



Hillier Way, Abbotts Barton



Mitford Road, Alresford



Symonds Close, Weeke

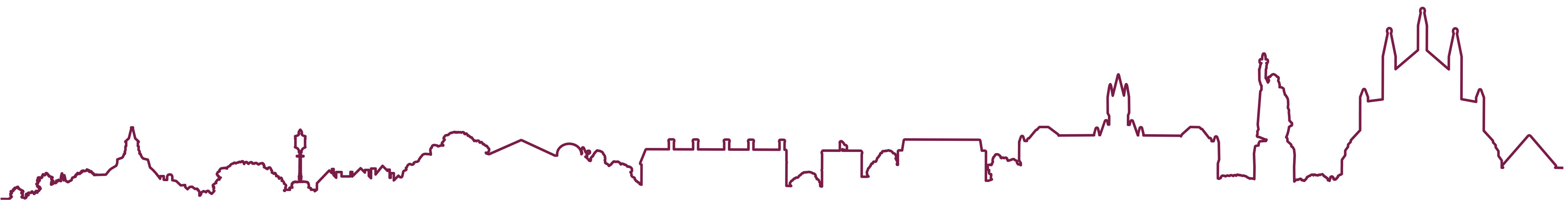



# Woodman Close • Sparsholt

## Communal Car Parking Options

April 2021

HOUSING FOR  WINCHESTER

Six on-street car parking spaces outside of the site would no longer be available. The council has consulted on the potential to provide additional communal car parking spaces within the wider area. The following option has been agreed and work is due to start in May 2021.

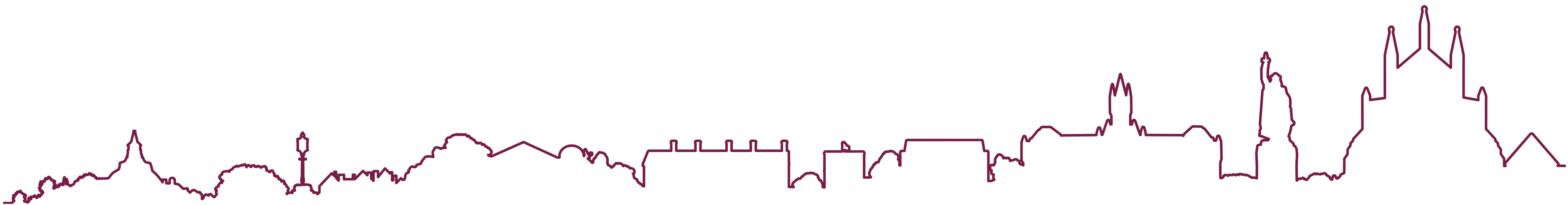
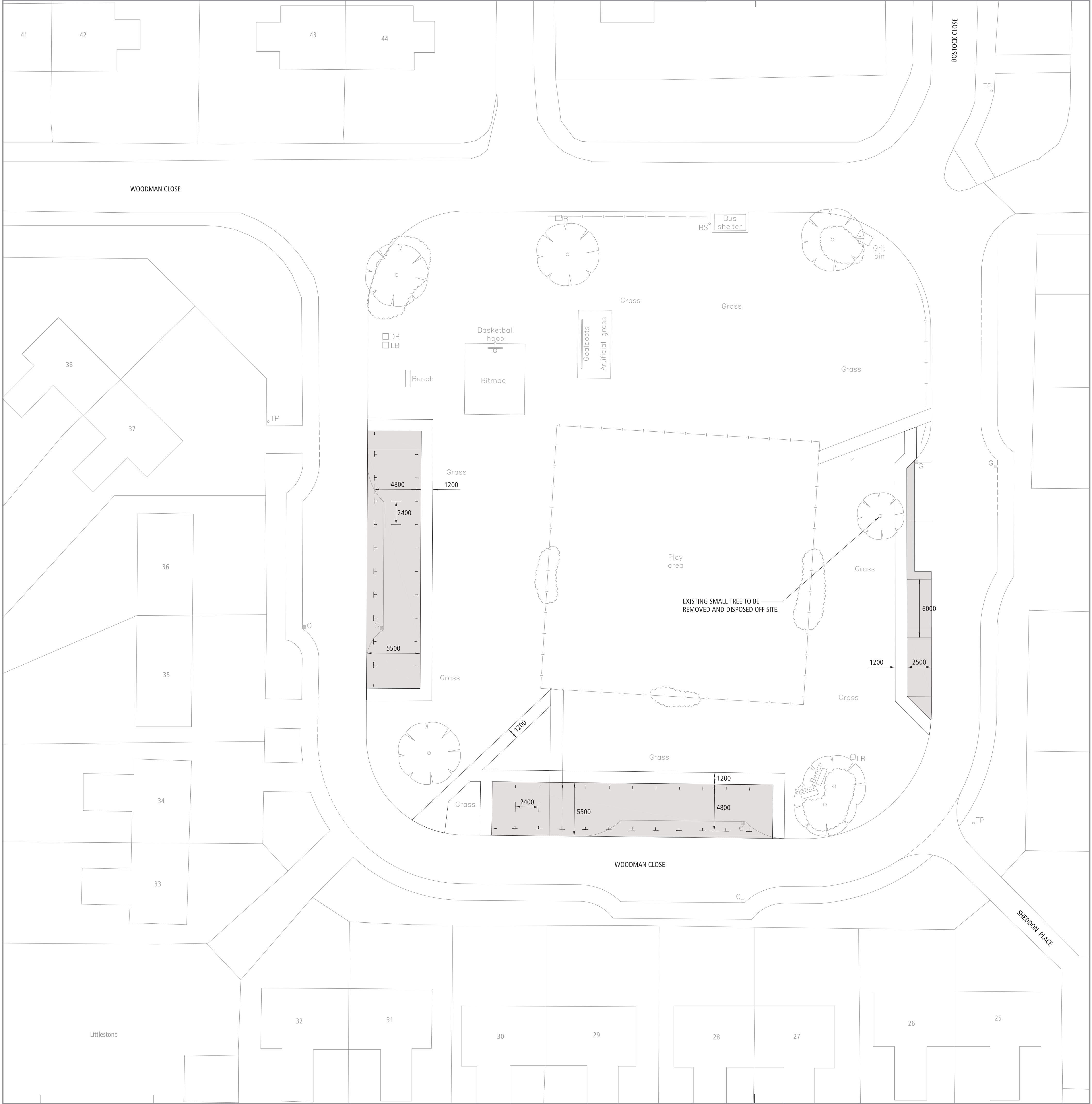



# Woodman Close • Sparsholt

## Next Steps

April 2021

HOUSING FOR   
**WINCHESTER**

After today's information event the council will review the comments and proposal to take forward to a planning application.

**April - May 2021**

Consultation

**May - June 2021**

Proposals reviewed

**Summer 2021**

Planning application

## FEEDBACK

**Thank you for watching this pre-recorded information event.**

- You can give feedback by email at **[newhomes@winchester.gov.uk](mailto:newhomes@winchester.gov.uk)**
- Comments received by Monday 10th May will be published by Monday 17th May 2021.
- If you are in housing need, or know of someone who is, please speak with members of the team or contact the Housing Allocations Team on **01962 848356**, or email **[housingallocations@winchester.gov.uk](mailto:housingallocations@winchester.gov.uk)**

**We look forward to hearing from you.**

