

- KEY**
- PROPOSED PARKING AREAS.
 - PROPOSED FOOTWAY.
 - PROPOSED CARBAGERWAY WIDENING.

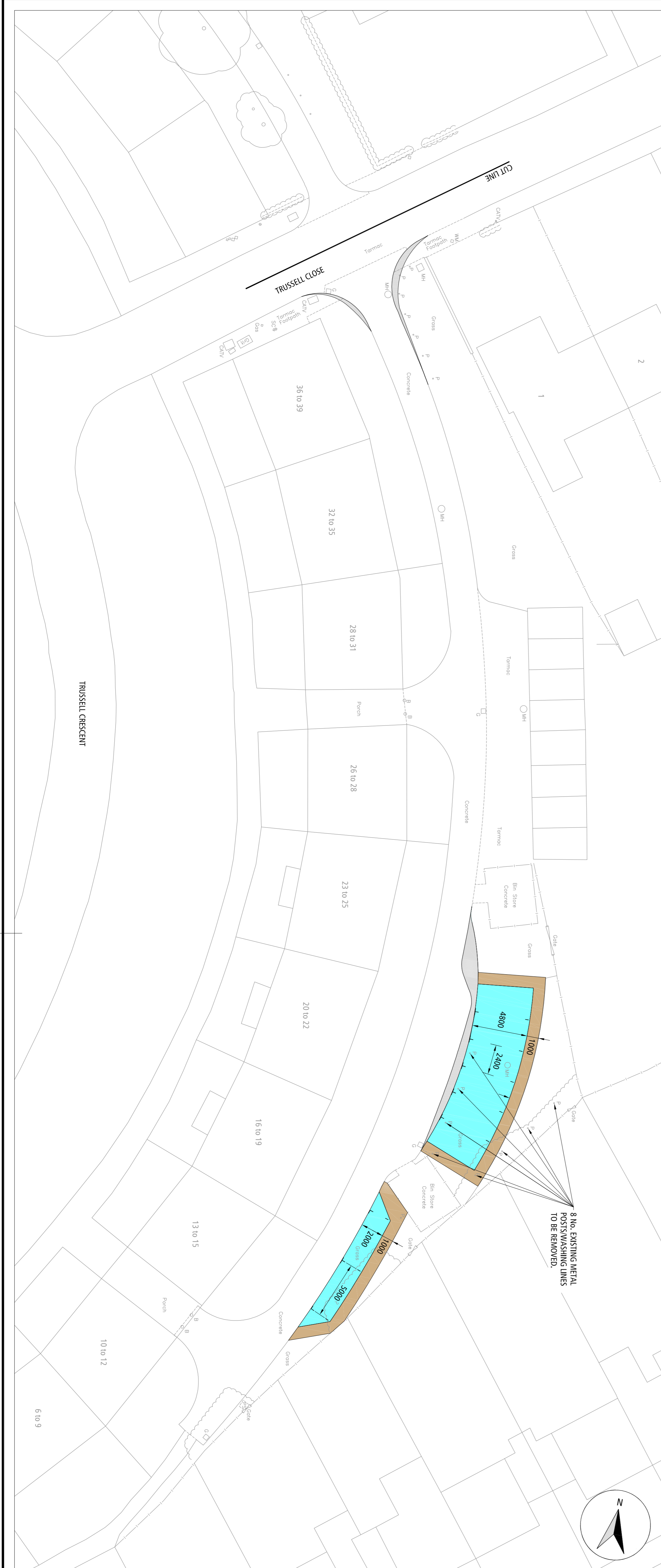

NOTES:

1. THE PROPOSED PARKING AREAS WILL BE CONSTRUCTED USING KERBS TOGETHER WITH NEW DRAINAGE AS REQUIRED.
2. THIS PROPOSAL PROVIDES A TOTAL OF 17 NEW RESIDENT PARKING BAYS.

| REV | Description | Date | Drawn |
|-----|-------------|------|-------|
| | | | |

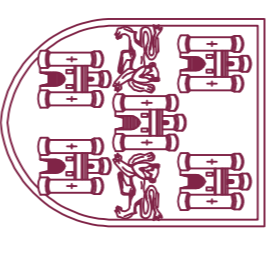

Winchester
City Council

ENGINEERING & TRANSPORT

PLACE

City Offices
Colebrook Street
Winchester
SO23 9LU

Project:

TRUSSELL CRESCENT,
WEEKE

Title:

PROPOSED ADDITIONAL
RESIDENTS PARKING

Scale: 1:200 @ A1

Date: 18/03/20

Drawn: CE

CAD: MCH

Checked: CIE

DRG. No.

7010002/5901

P