

HAMPSHIRE COUNTY COUNCIL
ROAD TRAFFIC REGULATION ACT, 1984
THE HAMPSHIRE (VARIOUS ROADS WINCHESTER)
(OFF STREET PARKING PLACES AND RESTRICTION OF WAITING) ORDER 2016

Winchester City Council (hereinafter referred to as "the Council") in exercise of its powers under Section 35 of the Road Traffic Regulation Act 1984 (which Act is hereinafter referred to as "the Act of 1984") and of Part IV of Schedule 9 to the Act of 1984, and of all other enabling powers and amending Acts with consent of Hampshire County Council and after consultation with the Chief Officer of Police in accordance with Part III of Schedule 9 of the Act of 1984 hereby make the following Order.

PART I - GENERAL

- 1 In this Order
- 1.1 "amenity or community group" means an amenity or other organisation which provides a service to the community and conducts regular daytime activities primarily intended for adults. For the purposes of these provisions the expression "amenity or community group" shall include St. Faith's School;
- 1.2 "the Council" means Winchester City Council;
- 1.3 "civil enforcement officer" has the same meaning as in Section 76 of the Traffic Management Act 2004
- 1.4 "customer" means any person visiting business premises for the purpose of purchasing goods or services thereat;
- 1.5 "disabled person's badge" has the same meaning as in the Disabled Persons (Badges for Motor Vehicles) (England) Regulations 2000;
- 1.6 "disabled person's vehicle" has the same meaning as in the Local Authorities' Traffic Orders (Exemptions for Disabled Persons) (England and Wales) Regulations 2000;
- 1.7 "driver" in relation to a vehicle waiting in a parking place, means the person driving the vehicle at the time it was left in the parking place;
- 1.8 "e-ticket" shall mean a ticket purchased by ringing the number prescribed and displayed in the parking place for that purpose, paying the tariff in accordance with Schedule 6 together with an additional fee payable for the use of the service, by the payment method specified and shall only be valid for the time specified and for the vehicle details given and for the parking place for which it was purchased

- 1.9 "goods" include postal packets of any description; and "delivering" and "collecting" in relation to any goods include checking the goods for the purpose of their delivery or collection;
- 1.10 "goods vehicle" means a motor vehicle which is constructed or adapted for use for the carriage of goods or burden of any description, and is not drawing a trailer;
- 1.11 "guest house" means those establishments registered with Winchester City Council which offer bed and breakfast facilities and have no more than 6 rooms available for hire to guests;
- 1.12 "Hackney Carriage" a vehicle licensed by Winchester City Council for the conveyance of passengers (does not include private hire vehicles).
- 1.13 "lay-by" means any area of carriageway intended for the waiting of vehicles and bounded partly by a traffic sign of the type shown in diagram 1010 in Schedule 6 to the Traffic Signs Regulations and General Directions 2002, and partly by the outer edge of that carriageway on the same side of the road as that on which the sign is placed;
- 1.14 "carriageway" in relation to a road specified in a Schedule means any carriageway of that road used primarily by through traffic and excludes any lay-by;
- 1.15 "inner area" means permit zones B, C, M, N, P, Q, R and S;
- 1.16 "motor cycle" means a mechanically propelled vehicle not being an invalid carriage with less than four wheels and the weight of which unladen does not exceed, 410 Kilograms;
- 1.17 "one-way street" means a highway in which vehicles are prohibited at all times from proceeding in any other than one direction;
- 1.18 "outer area" means permit zones A, D, E, F, G, H, I, J, K, L, O, T, U, V, W, X, and Y;
- 1.19 "owner" has the same meaning as in Section 92 of the Traffic Management Act 2004;
- 1.20 "parking disc" means a disc, issued by a local authority, 125 millimetres square, coloured blue if issued on or after the 1st April 2000 (or orange if issued before that date) and capable of showing the quarter hour period during which a period of waiting begins;
- 1.21 "parking place" means any part of any land or building specified by name in Column 1 of the Schedule to this Order and provided by the Council pursuant to the Act of 1984 for use as a public parking place as is further delineated in the plans in the Annex to this order;
- 1.22 "parking bay" means a space in a parking place, marked on the surface of the parking place by lines, studs or other indications, or indicated by notices which is provided for the parking of vehicles;
- 1.23 "parking ticket" means either:-
- a) a parking ticket issued by a ticket machine located in the vicinity of a parking place, for which payment has been made in accordance with the tariff specified in Schedule 6 to this Order and which authorises the parking of a vehicle in that parking place and displayed in the relevant position in accordance with the provisions of article 18 of this Order; or
 - b) an e-ticket
- 1.24 "passenger vehicle" means a motor vehicle which is constructed or adapted solely for the carriage of not more than twelve passengers, exclusive of the driver, and their effects and is not drawing a trailer;

- 1.25 "permit" means a permit issued under the provisions of this Order;
- 1.26 "permit holder" means a person or organisation to whom a permit has been issued under the provisions of this Order;
- 1.27 "permit zone" means each of those areas which comprises those roads and lengths of roads specified in Schedules to this Order and which is identified by the same letter of the alphabet in the right hand column of those Schedules and is further shown on the plans in the Annex to this Order
- 1.28 "plying for hire" being available for hire
- 1.29 "relevant position" means:
- in the case of a vehicle fitted with a front windscreen, a position thereon with the obverse side facing on the near side of and immediately behind the windscreen so that the date, time, parking place name and fee paid shown on the ticket are clearly visible from outside the vehicle;
 - in the case of a vehicle not fitted with a front windscreen, any other conspicuous position on the front of the vehicle so that the date, time, parking place name and fee paid shown on the ticket are clearly visible from outside the vehicle;
 - in the case of any disabled person's vehicle, relevant position shall be defined by Regulation 4 of the Local Authorities Traffic Orders (Exemptions for Disabled Persons) (England) Regulations 2000.
- 1.30 "relevant vehicle" means a passenger or goods vehicle with an unladen weight of 2 tonnes or less, provided that no such vehicle exceeds 6 metres in length;
- 1.31 "resident" means a person whose usual place of abode is at premises situated in any permit zone or who is the owner of any such premises which are undergoing renovation prior to being let. For the purposes of these provisions the expression "resident" shall not include a person pursuing a course of education or training who occupies premises designed for the purposes of multiple occupation and who is in actual occupation of part thereof for less than 40 weeks a year;
- 1.32 "telecommunications apparatus" has the same meaning as in the Telecommunications Act 1984;
- 1.33 "ticket machine" means an apparatus of a type and design approved by the Secretary of State in accordance with Section 35 (3) of the Act for the purpose of this Order, being apparatus designed to indicate the time by a clock and to issue parking tickets indicating the payment of charge and the date and time at which the payment was made.
- 1.34 "Verge" means any part of a road which is not a carriageway.
- 1.35 "Visitor" shall mean any person visiting or residing with the permit holder on the day or for the period that the vehicle is left in the parking place
- 2 The prohibitions and restrictions imposed by this Order shall be in addition to and not in derogation from any restriction or requirement imposed by any regulations made or having effect as if made under the Act or by or under any other enactment.

PART II - AUTHORISATION AND USE OF PARKING PLACES

- 3 Each of the parts of a road specified in Schedules 1, 4 and 5 to this Order is authorised to be used subject to the following provisions of this Order as a parking place for such classes of

vehicles, on such days and during such hours as are specified in relation to that part of the road in the said Schedules.

- 4 Any person duly authorised by the Council or a police constable in uniform may suspend the use of a parking place or any part thereof whenever he considers such suspension reasonably necessary provided that no such suspension effected solely by a police constable in uniform shall continue for a period greater than twenty-four hours.
- 5 Where in Schedule 1 to this Order a parking place is described as available for vehicles of a specified class, the driver of the vehicle shall not permit it to wait in that parking place:-
 - (a) during the available hours of use authorised under this Order; AND
 - (b) unless it is of the specified class; or
 - (c) unless it is a motorcycle; AND
 - (d) unless where required it displays a valid parking ticket as defined by Article 1 above or a valid e-ticket is in effect; or
 - (e) unless it is a disabled person's vehicle which displays in the relevant position a disabled person's badge; AND
 - (f) unless:
 - (i) if the parking place is not in a one-way street, the left or near side of the vehicle is adjacent to the left-hand edge of the carriageway;
 - (ii) if the parking place is in a one-way street the left or near side of the vehicle is adjacent to the left-hand edge of the carriageway or that the right or off-side of the vehicle is adjacent to the right-hand edge of the carriageway, and it is positioned within the parking areas defined by white lines on the surface of the road.
 - (iii) if the parking place is defined by white lines the vehicle is positioned within the area defined by the white lines
- 6 A driver of a vehicle shall not use a parking place:-
 - 6.1 so as unreasonably to prevent access to any premises adjoining the road, or the use of the road by other persons, or so as to be a nuisance;
 - 6.2 when the use of that parking place has been suspended in accordance with Article 5 of this Order.
- 7 The driver of a motor vehicle using a parking place shall stop the engine as soon as the vehicle is in position in the parking place, and shall not start the engine except when about to change the position of the vehicle in or to depart from the parking place.
- 8 No person shall use a vehicle, while it is in a parking place, in connection with the sale of any article to persons in or near the parking place or in connection with the selling or offering for hire of his skill or services unless he does so from the vehicle itself and the period of waiting does not exceed 20 minutes.

- 9 A disabled person's vehicle which displays in the relevant position a disabled person's badge shall be exempt from any limitation on time specified in column 5 of Part I of Schedule 1 to this Order.
- 10 In column 5 of Part I of Schedule 1 to this Order references to the period of time within which the return of a vehicle is prohibited shall be deemed to prohibit that vehicle from subsequently waiting in any of the parking places referred in that Schedule, within that period of time.
- 11 Subject to the proviso hereto, when a vehicle is left in a parking place in contravention of any of the provisions contained in Articles 4, 5, 6, and 7 of this Order a person authorised in that behalf by the Council may remove the vehicle or arrange for it to be removed from that parking place; provided that when a vehicle is waiting in a parking place in contravention of the provision of Article 6(f) of this Order, a person authorised in that behalf by the Council may alter or cause to be altered the position of the vehicle in order that its position shall comply with that provision.
- 12 Any person removing a vehicle or altering its position by virtue of the last preceding Article of this Order may do so by towing or driving the vehicle or in such other manner as he may think necessary and may take such measures in relation to the vehicle as he may think necessary to enable him to remove it or alter its position, as the case may be.
- 13 When a person authorised by the Council removes or makes arrangements for the removal of a vehicle from a parking place by virtue of Article 12 of this Order, he shall make such arrangements as may be reasonably necessary for the safe custody of the vehicle.
- 14 A police constable in uniform or a Civil Enforcement Officer may move or cause to be moved, in case of emergency, to any place he thinks fit, any vehicle left in a parking place.
- 15 Nothing in this Order shall:-
- 15.1 make it unlawful to cause or permit any vehicle to wait at any time in a parking place (other than a parking place or part of a parking place the use of which has been suspended), if:-
- (i) the vehicle is waiting only for so long as is necessary to enable a person to board or alight from the vehicle;
 - (ii) the vehicle is waiting owing to the driver being prevented from proceeding by circumstances beyond his control or to such waiting being necessary in order to avoid an accident;
 - (iii) the vehicle is a vehicle being used for fire and rescue service purposes, an ambulance, a vehicle under the control of a Doctor on Duty for so long as may be necessary for him to visit a patient, a vehicle in the service of a Local Authority or Health Authority or a vehicle in the service of a Police force in either case being used in pursuance of statutory powers or duties or a vehicle being used by a minister of religion for so long as may be necessary in the course of his duties;
 - (iv) the vehicle is waiting only for so long as may be necessary to enable it to be used in connection with the removal of any obstruction to traffic;
 - (v) the vehicle is in the service of or employed by Royal Mail or any company authorised to collect or deliver postal packets, and is waiting while postal packets addressed to premises adjacent to the parking place in which the vehicle is waiting are being unloaded from the vehicle, or, having been unloaded therefrom, are being delivered or while postal packets are being collected from premises or posting boxes adjacent to the parking place in

which the vehicle is waiting, or is in use in connection with the servicing of telephone kiosks adjacent to the parking place;

- (vi) the vehicle, not being a passenger vehicle, is waiting only for so long as may be reasonably necessary to enable it to be used for the purpose of any building operation, demolition or excavation in or adjacent to the parking place or the maintenance, improvement or reconstruction of the parking place or laying, erection, alteration, removal or repair in or adjacent to the parking place of any sewer or of any main, pipe or apparatus for the supply of gas, water or electricity or of any telecommunication apparatus or traffic sign;
- (vii) the vehicle is waiting only for so long as is necessary to enable goods to be loaded onto or unloaded from the vehicle;
- (viii) the vehicle is waiting to enable a pupil attending any school to be picked up or set down in connection with the attendance of that pupil at that school, provided no such period of waiting shall exceed 20 minutes;
- (ix) the vehicle is waiting to take in petrol, oil, water or air from any garage situated on or adjacent to the said parking place; or
- (x) the vehicle is waiting at or near to any premises situated on or adjacent to the said parking place for so long as is reasonably necessary in connection with any wedding or funeral.

15.2 make it unlawful to cause or permit any vehicle to be left in a parking place or part of a parking place the use of which has been suspended;

- (i) for any vehicle being used for fire and rescue services, ambulance or police purposes;
- (ii) or for any purpose specified in Article 16.2 (ii), (iv) or (v), to be left in that suspended parking place or part of a parking place;
- (iii) or for any other vehicle to be so left if that vehicle is left with the permission of the person suspending the use of the parking place or the part thereof in pursuance of Article 5.

16 A person causing or permitting a vehicle to wait in a parking place by virtue of the provisions of Article 16.1 (v), (vi), or (vii) of this Order shall take all such steps as are necessary to ensure that the vehicle waits in accordance with the requirements of Article 7 of this Order.

17 Where a parking ticket is required by a provision of this Order to be displayed in a vehicle it shall be placed in the vehicle on or adjacent to the front of its windscreen so as to be easily readable from the outside of the vehicle and shall be maintained in position during the whole of the time that its display is required to comply with a requirement of Articles 6 and 51 of this Order.

PART III - PERMITS

18 Any resident of the inner area may apply to the Council for the issue of a permit for the leaving of a relevant vehicle by that resident, any other person resident at the same address or by any visitor to that address at any time in any parking place specified in Schedule 1 to this Order situated in the same permit zone as that resident's usual place of abode, subject to no more than two such permits being available for use, one by a resident and one by a visitor, in respect of any one address; provided that any period of waiting by a vehicle left by a visitor shall not exceed the duration of such visit.

- 19 Any resident of the outer area may apply to the Council for the issue of a permit for the leaving of a relevant vehicle by that resident, any other person resident at the same address or by any visitor to that address at any time in any parking place specified in Schedule 1 to this Order situated in the same permit zone as that resident's usual place of abode, subject to no more than four such permits being available for use, two by residents and two by visitors, in respect of any one address; provided that any period of waiting by a vehicle left by a visitor shall not exceed the duration of such visit.
- 20 Any proprietor of business premises situated in the inner area, where those premises do not have sufficient off-street parking facilities to adequately meet the business needs of the business concerned, may apply to the Council for the issue of a permit for the leaving of a relevant vehicle by any customer of that business at any time in any parking place specified in Schedule 1 to this Order situated in the same permit zone as those business premises, for a period no longer than one hour in any one day, subject to no more than one such permit being available for use in respect of any one business address.
- 21 Any proprietor of business premises situated in the outer area, where those premises do not have sufficient off-street parking facilities to adequately meet the business needs of the business concerned, may apply to the Council for the issue of a permit for the leaving of a relevant vehicle by any customer of that business at any time in any parking place specified in Schedule 1 to this Order situated in the same permit zone as those business premises, for a period no longer than four hours in any one day SUBJECT TO no more than five such permits being available for use in respect of any one business address.
- 22 Any permit issued, in accordance with the provisions of Articles 19, 20, 21, 22 or 24 of this Order, in respect of any address in the roads or lengths of road specified in Schedule 7 to this Order maybe valid for an additional adjacent permit zone provided that the availability of permits shall be determined on the basis of the permit zone in which that address is situated.
- 23 Any proprietor of business premises situated in:-
 - 23.1 permit zones F and V may apply to the Council for the issue of a permit for the leaving of a relevant vehicle at any time in any parking place situated in the same permit zone as those business premises by any person normally employed at those premises;.
 - 23.2 permit zone V may apply to the Council for the issue of a permit for the leaving of a relevant vehicle at any time in any parking place situated in that permit zone by any customer of that business, subject to no more than 6 permits being available for use in respect of that business address.
- 24 Any proprietor of a guest house situated in the inner or outer areas may apply to the Council for the issue of a permit for the leaving of a relevant vehicle by any guest registered at those premises at any time in any parking place specified in Schedule 1 to this Order situated in the same permit zone as that guest house, subject to no more than one such permit being available for use in respect of each room available for hire to guests at any one guest house.
- 25 Any person or organisation whose premises are situated in the inner or outer areas may apply to the Council for the issue of a permit for the leaving of a relevant vehicle by any person attending those premises for the purpose of participating in activities organised by an amenity or community group, at any time in any parking place specified in Schedule 1 this Order situated in the same permit zone as those premises, subject to no more than 20 such permits being available for use in respect of any particular premises.
- 26 Subject to the Council's agreement, any existing resident permit holder may apply to the Council for 10 scratchcard permits(or such other form of replacement permit issued for this

purpose by the Council), each scratchcard to be valid for the leaving of a relevant vehicle by any person visiting that resident at any time on the day indicated on the scratchcard, in any parking place referred to in Part I of Schedule 1 to this Order and located in the same zone as the resident's address, on any of those parts of road specified in Parts II, III, IV, VII, VIII, IX, X, XIII, XVII XIX, XXII, XXIV, XXV, XXVIII or XXIX of that Schedule, provided that no more than 20 such permits are issued in respect of any one address during any calendar year.

- 27 Any proprietor of any business may apply to the Council for the issue of a permit for the leaving of a relevant vehicle in any permit zone for a period no longer than two hours in any 24 hour period by any employee of that business for the purpose of attending a customer's premises located within that permit zone.
- 28 The Council may require an applicant for a permit or a permit holder to produce such evidence in respect of the application as they may reasonably require to verify any particulars of information given to them. Any such application shall be made on a form issued by the Council and shall include the particulars and information required by such form to be supplied.
- 29 The Council, upon being satisfied that details supplied by an applicant are accurate, and that the applicant is eligible in accordance with the provisions of this Order, to be issued with the permit or permits applied for, and on receipt of the appropriate fee as specified in Schedule 6 to this Order, and subject to the provision of Article 31 of this Order, may issue such a permit or permits to the applicant for the leaving of a relevant vehicle as provided in the relevant article of this Order, by the owner or by any person using such vehicle with the consent of the owner (other than a person to whom such a vehicle has been let for hire or reward). Subject to Articles 27, 31, 34, and 36 of this Order, all such permits shall be valid for a period of twelve months.
- 30 The total number of permits referred to in Article 19 or 20 of this Order which may be issued to all residents of any property or properties constructed, converted or extended pursuant to a planning permission granted after 30 May 2002 in respect of any particular site shall not exceed the total permit entitlement of all residents of the property or properties which occupied the same site at the time planning permission was granted.
- 31 A discount for the appropriate fee as specified in Schedule 6 to this Order for the first permit issued in accordance with Article 19 and 20 shall be made for Vehicles with CO₂ emissions as follows;

Emissions of 100g/km or less – 75% discount

Emissions from and including 101-120 g/km – 50%

- 32 A permit holder
 - 32.1 may surrender a permit to the Council at any time; and
 - 32.2 shall surrender a permit to the Council on the occurrence of any of the events set out in Article 35 of this Order;
- and a permit holder who surrenders a permit
- (a) before the permit becomes valid shall be entitled to a refund of the fee paid in respect thereof;
 - (b) after the permit has become valid shall be entitled to a refund calculated on the balance of the period remaining unexpired at the time when the permit is surrendered to the Council, to a minimum value of £10.00;

provided that no refund is payable if the permit is surrendered as a consequence of any of the events specified in Article 35(d), (e), (f) or (g) of this Order.

- 33 The Council may, by notice in writing served on the permit holder at the address shown by that person on the application for the permit or at any other address believed to be that person's residence, withdraw a permit if it appears to the Council that any of the events set out in Article 35 of this Order has occurred, and the permit holder shall surrender the permit to the Council within 48 hours of the receipt of the said notice.
- 34 The events referred to in Article 29 and 30 of this Order are:-
- (a) the permit holder ceasing to be a resident;
 - (b) the permit holder ceasing to be the owner of the vehicle in respect of which a permit was issued;
 - (c) the vehicle in respect of which such permit was issued being adapted or used in such a manner that it is not a relevant vehicle;
 - (d) the issue of a duplicate permit by the Council following an application made under the provisions of Articles 33 or 34 of this Order;
 - (e) the expiry of the period for which the permit was issued;
 - (f) a cheque, cash or credit card or electronic transfer received from the permit holder as payment of the appropriate fee in respect of the permit being subsequently dishonoured or any information supplied in support of a permit application being subsequently found to be false;
 - (g) the permit having been used in respect of a vehicle which is not a relevant vehicle;
 - (h) the permit having been used by any person not authorised to do so under the provisions of this order; and
 - (i) the permit having been used in respect of a vehicle which has been parked in a parking place unreasonably so as to prevent access to premises adjoining the road, to obstruct other road users or cause a nuisance.
 - (j) the permit having been sold or given to someone who is not a visitor or a resident in which case the person responsible for the transfer of the permit may at the discretion of the parking Manager be refused any further permits

Provided that sub-paragraphs (b) and (c) of this Article shall only have effect in respect of a permit restricted to a specified relevant vehicle.

- 35 A permit shall cease to be valid on the occurrence of any one of the events set out in Article 35 of this Order.
- 36 If a permit is mutilated or defaced or the figures or particulars on it have become illegible or the colour of the permit has become altered by fading or otherwise, the permit holder shall surrender it to the Council and may then apply to the Council for the issue of a duplicate permit.
- 37 If a permit is lost or destroyed, the permit holder may apply to the Council for the issue of a duplicate permit.
- 38 The provisions of this Order shall apply to a duplicate permit and an application for such a permit as if it were a permit or, as the case maybe, an application for a permit.

- 39 Any application for a duplicate permit under the provisions of Articles 37, 38 or 39 of this Order shall include the appropriate fee as specified in Schedule 6 to this Order, and upon the issue of a duplicate permit the permit which it duplicates shall become invalid.
- 40 A permit shall be in writing and shall include the following particulars:-
- (a) the registration mark of the vehicle in respect of which the permit has been issued or the address of the permit holder;
 - (b) the zone or zones in respect of which the permit is valid;
 - (c) the period during which, subject to the provisions of Article 32 of this Order, the permit shall remain valid; and
 - (d) an authentication that the permit has been issued by the Council.
- 41 Whenever a vehicle has been left in a parking place during any period when it would not otherwise be authorised to wait there shall be displayed on, or adjacent to, the near side of the front windscreen of the vehicle a permit valid in respect of that vehicle and parking place so that all the particulars referred to in Article 41 of this Order are clearly legible from outside the vehicle.
- 42 When a permit has been displayed on a vehicle in accordance with the provisions of Article 42 of this Order, no person shall remove the permit from the vehicle unless authorised to do so by the driver of the vehicle.
- 43 The Council having issued a permit to any applicant in respect of any premises under Article 21, 22, 25, or 26 of the Order the applicant shall not be entitled to make any further application in respect of those premises under any other of those Articles.

PART IV - RESTRICTION OF WAITING

- 44 Save as provided in Articles 46, 47, 48, 49, and 52 of this Order, no person shall cause or permit any vehicle to wait:-
- (a) at any time on any of the sides of road specified in Schedules 2, 3 and 4 to this Order;
 - (b) between the hours of 8.00am and 6.00pm from Monday to Saturday (both days inclusive) on any of the sides of road specified in Schedule 5 to this Order.
- 45 Nothing in Article 45 of this Order shall render it unlawful to cause or permit any vehicle to wait on any of the sides or road referred to in that Article upon the direction or with the permissions of a police constable in uniform or Civil Enforcement Officer, or with the permission of the Chief Officer of Police given by means of an exemption certificate displayed on or adjacent to the nearside of the front windscreen of the vehicle, provided that no condition imposed on the use of that certificate at the time of issue has been breached.
- 46 Nothing in Article 45 of this Order shall render it unlawful to cause or permit any vehicle to wait on any of the sides of road referred to in that Article for so long as may be necessary:-
- (a) to enable a person to board or alight from the vehicle;
 - (b) to enable the vehicle, if it cannot conveniently be used for such purpose in any other road, to be used in connection with the following operations namely:-
 - (i) building or demolition;

- (ii) the removal of any obstruction to traffic;
- (iii) the maintenance, improvement or reconstruction of the said sides of road;
- (iv) the laying, erection, alteration or repair in, or in land adjacent to, the said sides of road, of any sewer or of any main, pipe or apparatus for the supply of gas, water or electricity or any telecommunications apparatus;
- (c) to enable the vehicle, if it cannot conveniently be used for such purpose in any other road, to be used in the service of a local authority or a water authority in pursuance of statutory powers or duties;
- (d) to enable the vehicle to be used in the service of Royal Mail or any company authorised to collect or deliver postal packets, for the purpose of delivering or collecting postal packets as defined in the Postal Services Act 2000;
- (e) to enable the vehicle to take in petrol, oil, water or air from any garage situated on or adjacent to the said sides of road;
- (f) to enable the vehicle to wait at or near to any premises situated on or adjacent to the said sides of road for so long as is reasonably necessary in connection with any wedding or funeral;
- (g) to enable the vehicle to be used for fire and rescue services, ambulance or police purposes; or
- (h) to enable the vehicle to wait owing to the driver being prevented from proceeding by circumstances beyond his control or to such waiting being necessary in order to avoid an accident.

47 Save as provided in Article 49 of this Order, nothing in Article 45 of this Order shall render it unlawful to cause or permit any vehicle to wait on any of the sides of road specified in Schedules 2, 4 and 5 to this Order for so long as may be necessary to enable goods to be loaded onto or unloaded from the vehicle.

48 Save as provided in Article 49 of this Order, nothing in Article 45 of this Order shall render it unlawful to cause or permit a disabled person's vehicle which displays in the relevant position a disabled person's badge and a parking disc (on which the driver or other person in charge of the vehicle has marked the time at which the period of waiting began) to wait on any of the sides of road specified in Schedules 2, 4 and 5 to this Order for a period not exceeding three hours (not being a period separated by an interval of less than one hour from a previous period of waiting by the same vehicle on the same side of road on the same day).

49 Articles 48 and 49 of this Order shall not apply in respect of any of the sides of road specified in Schedule 4 to this Order between the hours of 7.30 a.m. and 9.30 a.m., and 4.30 p.m. and 6.00 p.m. from Monday to Saturday (both days inclusive).

Parking Tickets

50 Where required under this Order to pay a charge for parking,

- 50.1 the driver of a vehicle shall, upon depositing the vehicle in a parking place, immediately pay the appropriate charge applicable to the class of vehicle, and period of parking ascertained by reference to Schedule 6
- 50.2 No person shall exhibit on any vehicle, any parking ticket, permit or disabled person's badge upon which the figures or particulars have become illegible or altered in any way by anyone other than a person duly authorised by the Council.
- 50.3 Where any parking apparatus is defective or is not installed in a car park the charge referred to in Article 51.1 may be collected by a civil enforcement officer.
- 50.4 A vehicle left by the driver thereof who has been issued with a permit by the Council for the purpose of leaving the vehicle in a parking place for such time as that vehicle is parked in consequence of the driver's duty or business on behalf of the Council shall be exempted from payment of the charges specified in Schedule 6 hereto

PART V -- HACKNEY CARRIAGES

51 Nothing in this Order shall:

- (a) render it unlawful to cause or permit any vehicle to wait on any side of road if that vehicle is a hackney carriage plying for hire at an authorised hackney carriage stand;
- (b) be deemed to authorise or permit any vehicle which is not a hackney carriage to wait at an authorised hackney carriage stand;
- (c) render it lawful for a hackney carriage driver to leave a hackney carriage unattended at an authorised hackney carriage stand.

during any period that that stand is so authorised.

52 This Order shall come into operation on 01 August 2017 ~~2016~~ and may be cited as "The Hampshire (Various Roads Winchester) (Off Street Parking Places And Restriction Of Waiting) Order 2016"

GIVEN this 25th day of July 2017

THE COMMON SEAL of WINCHESTER)
CITY COUNCIL was hereunto)
affixed in the presence of:-

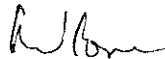

Head of Legal and Democratic Services



SCHEDULE 1Roads in the City of WinchesterParking PlacesPART I

1	2	3	4	5
Situation of parking place	Class of vehicles	Days of operation of parking place	Hours of operation of parking place	Maximum period for which vehicles may wait
Those parts of road specified in Part II of this Schedule to a width throughout of 1.8 metres measured at right angles from the edge of the carriageway	Vehicles displaying a permit issued in accordance with this Order	Mondays to Saturdays	8:00 am to 10.00 pm	No limit
Those parts of road specified in Part III of this Schedule marked on the road as echelon Parking	Vehicles displaying a permit issued in accordance with this Order	Mondays to Saturdays	8:00 am to 10.00 pm	No limit
Those parts of road specified in Part IV of this Schedule to a width of 1.8 metres	Disabled permit holders only	all days	all hours	No limit
Those parts of road specified in Part V of this Schedule marked on the road as echelon Parking	Disabled permit holders only	all days	all hours	No limit

Roads in the City of Winchester
**Schedule 1 Pt II Permit Holders Only 8.00am to
 10.00pm Monday to Saturday**

<u>Road Name</u>	<u>Side</u>	<u>Description</u>	<u>Zone</u>
EASTGATE STREET	OFF-ROAD PARKING AREA AT GREYFRIARS	AS DRAWING NO. 810402/383/001A SEE ANNEXE A TO ORDER PLAN A	N

Roads in the City of Winchester
**Schedule 1 Pt III Echelon Permit Holders Only 8.00am to
 10.00pm Monday to Saturday**

<u>Road Name</u>	<u>Side</u>	<u>Description</u>	<u>Zone</u>
EASTGATE STREET	OFF-ROAD PARKING AREA AT GREYFRIARS	AS DRAWING NO. 810402/383/001A. SEE ANNEXE A TO ORDER PLAN A	N
LOWER BROOK STREET	OFF-ROAD PARKING AREA ON EAST SIDE OF ROAD	AS DRAWING NO. 810402/383/002. SEE ANNEXE A TO ORDER PLAN B	N

Roads In the City of Winchester
**Schedule 1 Part IV Disabled Permit Holders Only
 All Days**

<u>Road Name</u>	<u>Side</u>	<u>Description</u>	<u>Zone</u>
EASTGATE STREET	OFF-ROAD PARKING AREA AT GREYFRIARS	AS DRAWING NO. 810402/383/001A. SEE ANNEXE A TO ORDER PLAN A	N

Roads In the City of Winchester
**Schedule 1 Part V Echelon Disabled Permit Holders Only
 All Days**

<u>Road Name</u>	<u>Side</u>	<u>Description</u>	<u>Zone</u>
EASTGATE STREET	OFF-ROAD PARKING AREA AT GREYFRIARS	AS DRAWING NO. 810402/383/001A. SEE ANNEXE A TO ORDER PLAN A	N

Roads In the City of Winchester

15
Schedule 2
No Waiting At Any Time

<u>Road Name</u>	<u>Side</u>	<u>Description</u>	<u>Zone</u>
EASTGATE STREET	OFF-ROAD PARKING AREA AT GREYFRIARS	AS DRAWING NO. 810402/383/001A. SEE ANNEXE A TO ORDER PLAN A	N

SCHEDULE 6

Fees for Parking Permits

The fees referred to in Articles 28 and 36 of this Order shall be:-

Type of Permit

Inner area resident and/or visitors (Article 18)

permit per annum a) First permit £22.00 per

b) Second permit £50.00 per permit per annum

Outer area residents and/or visitors (Article 19)

a) First permit

£22.00 Per permit per annum
b) second, third and fourth permit

£50.00 Per permit per annum

Business (Customers) (Articles 20,21 and 23 (2)) £50.00 Per permit per annum

Business (Staff) (Article 23(1))

Per permit per annum

£300.00

Guest Houses (Article 24)

£25.00 Per permit per annum

Amenity or Community Groups (Article 25)

£15.00 Per permit per annum

Business (All zones) (Article 26)

Per permit per annum

Duplicate (Articles 33 and 34)

£10.00

Resident Scratchcard Permit Book (Article 25A)
£10.00 per book

Business Zone V (Customers)

£50.00

Per permit per annum

SCHEDULE VII

Fees for Pay and display Parking ticketsPeriodMondays to Saturdays Fee

Up to and including 30 minutes £0.50p

31 to 60 minutes £1.20p

61 to 90 minutes £2.00p

91 to 120 minutes £2.50p

Sundays

1) Unless specified below FREE

2) As follows:- £2

Road Name	Side	Description
PARCHMENT STREET	EAST	BETWEEN A POINT 61.0 METRES NORTH-EAST OF ITS JUNCTION WITH ST GEORGES STREET AND A POINT 75.0 METRES NORTH-EAST OF THAT JUNCTION.
NORTH WALLS	SOUTH	BETWEEN A POINT 38.1 METRES EAST OF ITS JUNCTION WITH UPPER BROOK STREET AND A POINT 13.9 METRES WEST OF ITS JUNCTION WITH MIDDLE BROOK STREET

NORTH WALLS	NORTH	BETWEEN A POINT 70.5 METRES SOUTH EAST OF ITS JUNCTION WITH PARK AVENUE AND A POINT 112.7 METRES SOUTH-EAST OF THAT JUNCTION
ST PETER STREET	WEST	BETWEEN A POINT 42.9 METRES NORTH-EAST OF ITS JUNCTION WITH ST GEORGES STREET AND A POINT 54.1 METRES NORTH EAST OF THAT JUNCTION
ST PETER STREET	WEST	BETWEEN A POINT 61.5 METRES NORTH-EAST OF ITS JUNCTION WITH ST GEORGES STREET AND A POINT 84.2 METRES NORTH EAST OF THAT JUNCTION
COLEBROOK STREET	EAST	BETWEEN A POINT 66.6 METRES SOUTH OF ITS WESTERLY JUNCTION WITH HIGH STREET AND A POINT 88.8 METRES SOUTH OF THAT JUNCTION
HIGH STREET (B3331)	NORTH	BETWEEN A POINT 145.2 METRES SOUTH-EAST OF ITS JUNCTION WITH MIDDLE BROOK STREET AND A POINT 153.9 METRES SOUTH-EAST OF THAT JUNCTION
HIGH STREET (B3331)	SOUTH	BETWEEN A POINT 40.9 METRES SOUTH-EAST OF ITS WESTERLY JUNCTION WITH COLEBROOK STREET AND A POINT 58.5 METRES SOUTH-EAST OF THAT JUNCTION
MARKET LANE	SOUTH	BETWEEN A POINT 2.2 METRES WEST OF ITS JUNCTION WITH COLEBROOK STREET AND A POINT 23.1 METRES WEST OF THAT JUNCTION
THE SQUARE	SOUTH	BETWEEN A POINT 36.5 METRES EAST OF ITS JUNCTION WITH GREAT MINSTER STREET AND A POINT 15.5 METRES WEST OF ITS JUNCTION WITH MARKET STREET
HIGH STREET (B3331) CENTRE LANE	NORTH	BETWEEN ITS JUNCTION WITH KING ALFREDS STATUE AND A POINT 51.6 METRES WEST OF THAT JUNCTION

SCHEDULE 7

Roads and Lengths of Roads in the City Of Winchester, where permits may be valid for an additional adjacent permit zone

- i. The length of Andover Road between its junction with Stockbridge Road/City Road and property nos. 62 and 59 inclusive.
- ii. The length of Stockbridge Road between its junction with Andover Road and its junction with Cheriton Road and Bereweeke Road.
- iii. The length of Worthy Road between its junction with Worthy Lane/Hyde Street and the properties known as "Salcot" and "Barton Edge" (inclusive).
- iv. Newburgh Street numbers 5 -9 inclusive
- v. The length of Upper Brook Street between its junction with Friarsgate and its junction with St Georges Street.
- vi. The following roads for their entire lengths:-

<u>Roads</u> Bar End Road Eastgate Street High Street <u>Roads</u> North Walls Southgate Street Station Road Wales Street	<u>Roads</u> Chesil Street Friarsgate Jewry Street <u>Roads</u> Ranelagh Road St. Cross Road Sussex Street Worthy Lane	<u>Roads</u> City Road Gladstone Street Magdalen Hill <u>Roads</u> Romsey Road St Georges Street Upper High Street Worthy Road
---	--	--

SCHEDULE 8

Additional Roads in the City of Winchester where Residents are eligible for permits

<u>Road/Path</u>	<u>Zone</u>
Chesil Street	W
Highfield Terrace	J
Hyde Church Path	I
Middle Road	J
North View	J
Prinstead Close	X
St James Terrace	U/J
St Swithuns Terrace	C
St Swithuns Villas	C
South View	J
South View Access Road	J
Step Terrace	J
Wolvesey Terrace	W

© Crown copyright and database rights
Winchester City Council license 100019531



- PERMIT HOLDERS ONLY
800AM TO 1000PM
MONDAY TO SATURDAY
- DISABLED BADGE
HOLDERS ONLY
- NO WAITING AT ANY
TIME (DOUBLE YELLOW
LINES)

NO	DESCRIPTION	DATE	BY
1	Drawn	25/05/2016	NVC



Winchester
City Council

OPERATIONS GROUP
BUILT ENVIRONMENT

City Offices
Coburn Street
Winchester
SO23 9LJ



© Winchester City Council

Project:

OFF-STREET
PARKING ORDER

Title:

PROPOSED PARKING
RESTRICTIONS
GREYFRIARS
EASTGATE STREET
WINCHESTER

Scale: NTS

Date: 25/05/2016

Drawn: NVC

Checked:

DRG. No. 810402/383/001 A

Status:

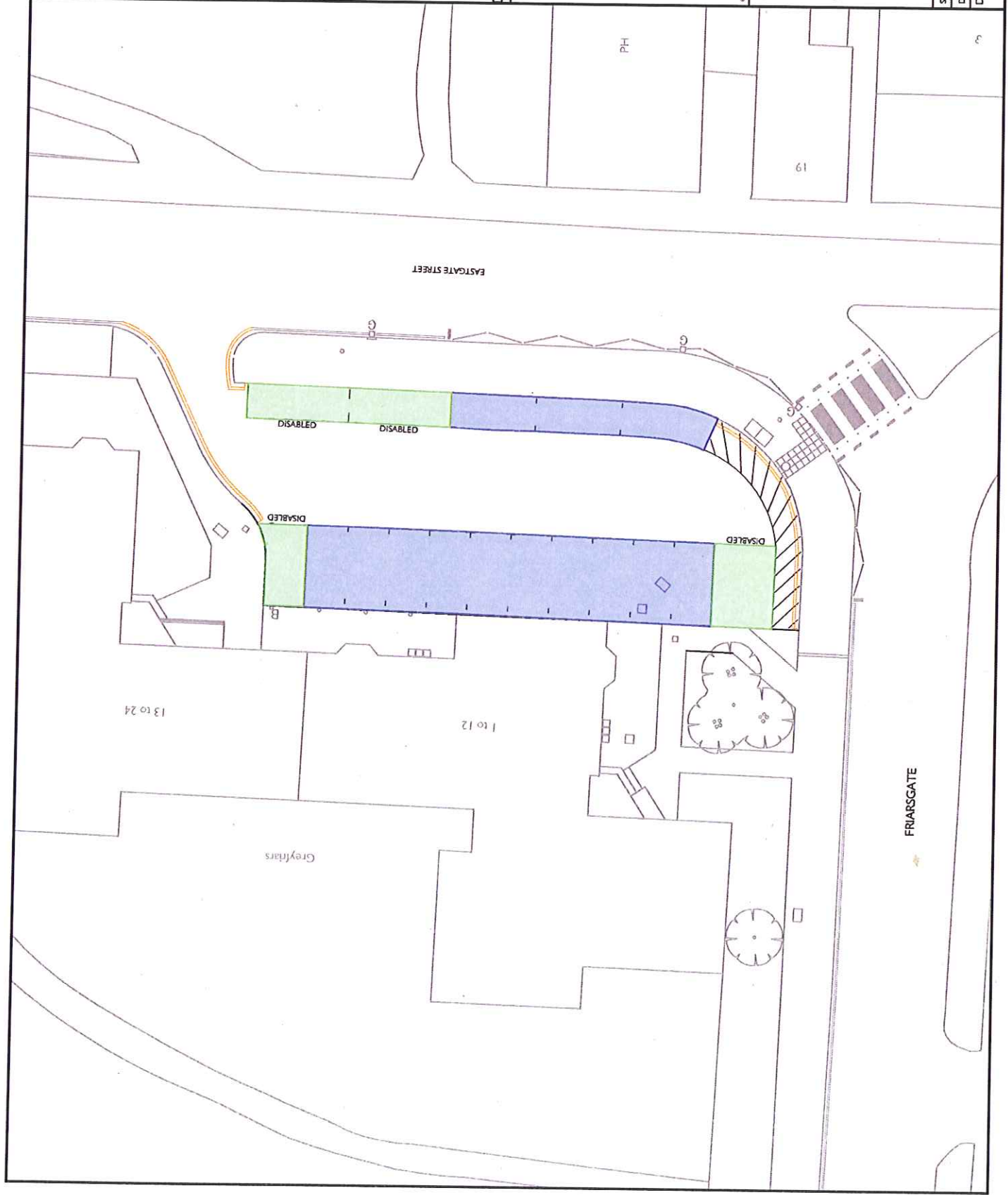

© Crown copyright and database rights.
Winchester City Council license 100019521



PERMIT HOLDERS ONLY
8:00AM TO 10:00PM
MONDAY TO SATURDAY



Scale	Description	Scale	Description
1:1000	1:1000	1:1000	1:1000



Winchester
City Council

OPERATIONS GROUP
BUILT ENVIRONMENT

City Office
College Street
Winchester,
SO23 9JL



© Winchester City Council

Project:

OFF-STREET
PARKING ORDER

Title:

PROPOSED PARKING
RESTRICTIONS

LOWER BROOK STREET
WINCHESTER

Scale: 1:1000	Date: 25/05/2016
Drawn: JVC	Checked:
Doc. No. 810402/393/002	Sheet:

